

THIS DRAWING IS UNPUBLISHED. RELEASED FOR PUBLICATION, 19 .
 © COPYRIGHT 19 BY AMP INCORPORATED. ALL INTERNATIONAL RIGHTS RESERVED.

| | | | | | | | | |
|-----|------|-----------|---|------|-----|------------------------------|---------|------|
| LOC | DIST | REVISIONS | | | | | | |
| AJ | 16 | P | F | ZONE | LTR | DESCRIPTION | DATE | APPD |
| | | | | | F | OBSOLETE -9 PER OU20-0072-01 | 12APR01 | MO |

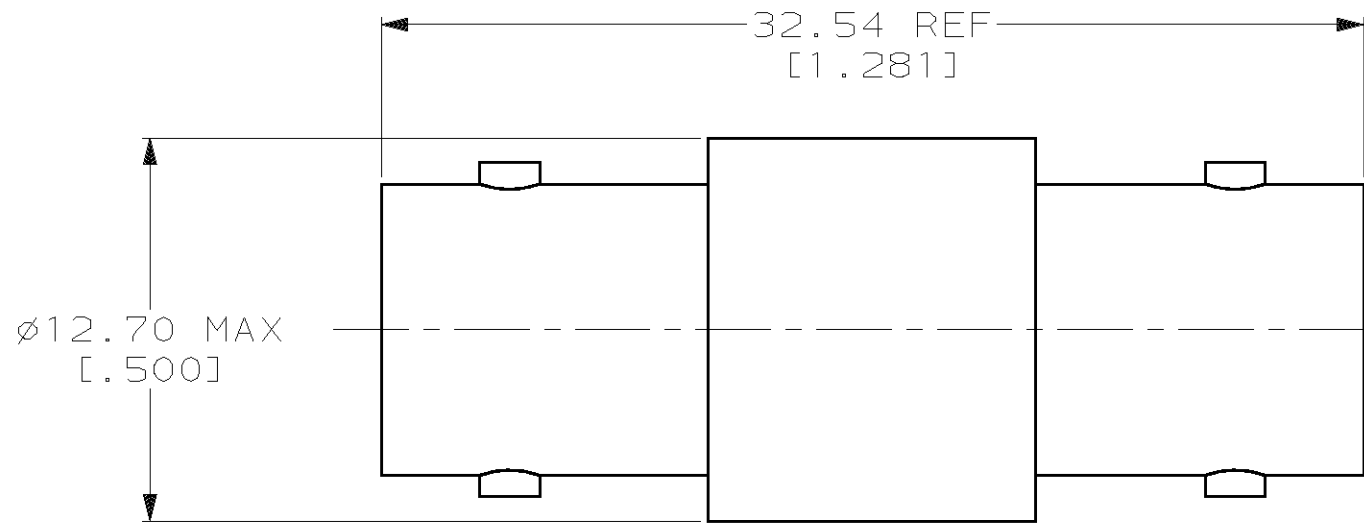

1. PART MAY BE INTER-MATED WITH PRODUCT PER MIL-C-39012
2. GOLD PLATING PER MIL-G-45204
3. NICKEL PLATING PER QQ-N-290
4. SILVER PLATING PER QQ-S-365
5. SEE SEPARATE RESTRICTED CUSTOMER DRAWING 221551-9

| | | | | |
|---------------|----------|---------------|---|-------------|
| | OBSOLETE | 2 | 3 | 1-221551-0 |
| | OBSOLETE | 5 | - | 221551-9 |
| SUPERSEDED BY | 221551-3 | 2 | 4 | 221551-4 |
| | | 2 | 3 | 221551-3 |
| SUPERSEDED BY | 221551-1 | 4 | 4 | 221551-2 |
| | | 4 | 3 | 221551-1 |
| | | CONTACT SHELL | | PART NUMBER |
| | | FINISH | | |

| | | | | |
|-------------------------------------------------------------------------------------------------------------------------------|------------------------------|-----------------------------|---------------------------------------------------|-----------------|
| DO NOT SCALE PRINT. UNLESS SPECIFIED DIMENSIONS IN mm [INCHES] TOLERANCES ON: 2 PLC DEC ± - 3 PLC DEC ± - ANGLES ± - | | DR 5-10-91 M.E. COWHER | AMP AMP Incorporated Harrisburg, PA 17105-3608 | |
| MATERIAL - | CHK 5-117-91 J.T. LIPPERT | APPD 5-24-91 M. PHILLIPS | NAME ADAPTER, FEED THRU, JACK, SERIES BNC | |
| FINISH 2 3 4 | APPD 6-5-91 M.E. COWHER | PRODUCT SPEC - | SIZE B | CAGE CODE 00779 |
| | APPLICATION SPEC - | WEIGHT - | DRAWING NO 221551 | SCALE 4:1 |
| | | | SHEET 1 OF 1 | |